

Crossgate House

First Floor

5,521 – 11,688 sq ft

Crossgate House occupies a prominent position on the corner of Atkinson Road and Cross Street (A56), close to the thriving town centre of Sale.

The accommodation offers Grade A specification office space accessed via an impressive glazed reception area. As well as being located in a strategic position, Crossgate House is easily accessible from the major road networks around the North West.

Crossgate House benefits from the amenities of Sale Town Centre and is just a 10 - 15 minute drive from Manchester Airport and Manchester City Centre. The building is also situated within walking distance from Dane Road Metrolink which provides regular services to Manchester City Centre and Altrincham.

For more information on this property:

📞 01625 588200

🌐 www.orbit-developments.co.uk

DISCLAIMER: These Particulars are believed to be correct at time of going to Press, but the Developer reserves the right to change the scheme in the future. However, the Vendors / Lessors and Agents of this property give notice that : (1) These Particulars are intended as a general outline only, for the guidance of prospective purchasers or tenants, and do not constitute the whole or any part of an offer or contract. (2) They cannot guarantee the accuracy of any description, dimension or other details contained in these Particulars and prospective purchasers or tenants should not rely on them as statements of fact or representation, but must satisfy themselves as to the accuracy of such details. (3) No employee of the Agents has any authority to make or give any representation or warranty, or enter into any contract whatsoever in relation to the property.

CROSSGATE HOUSE AVAILABILITIES

FIRST FLOOR

Atkinson Road Wing	5,575 sq ft	518 sq m
Cross Street Wing	5,521 sq ft	513 sq m
Total	11,096 sq ft	1,031 sq m
Total with lobby	11,688 sq ft	1,086 sq m

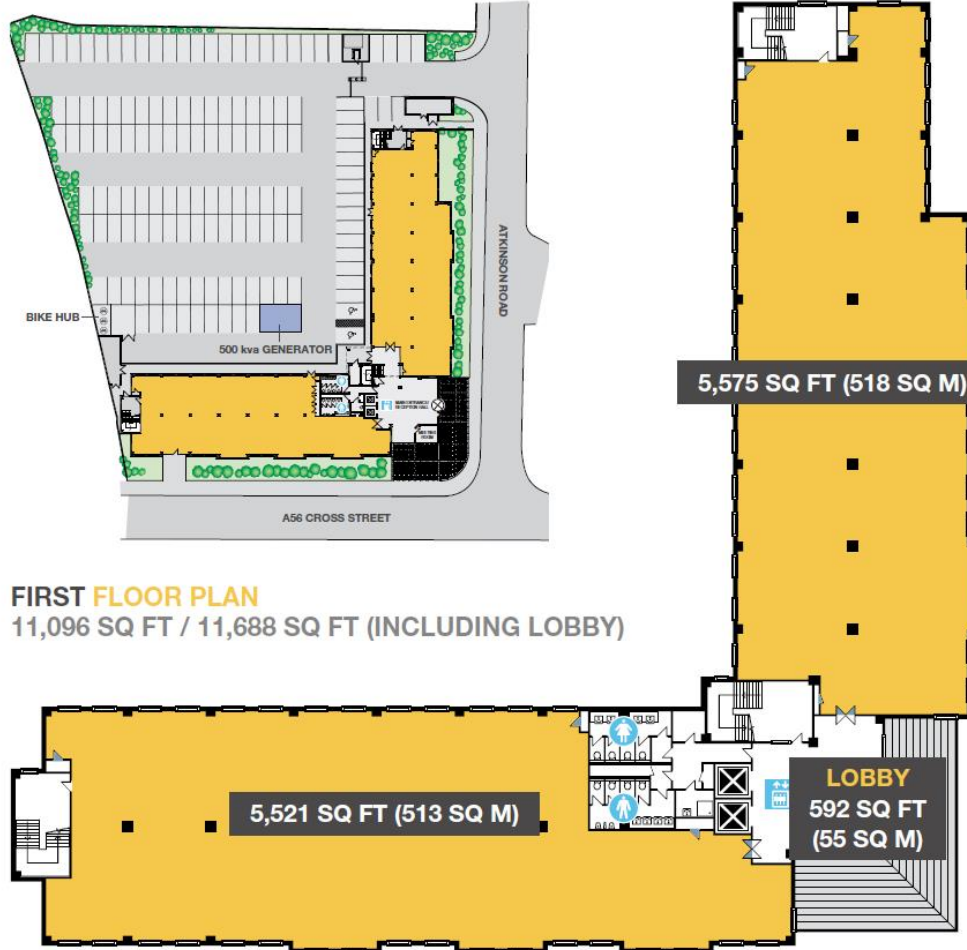

FIRST FLOOR PLAN

11,096 SQ FT / 11,688 SQ FT (INCLUDING LOBBY)

